

HM-10FTC1 规格书 (FeedThrough Filter 馈通滤波器)

1. Outline Drawing and Dimensions:(mm)

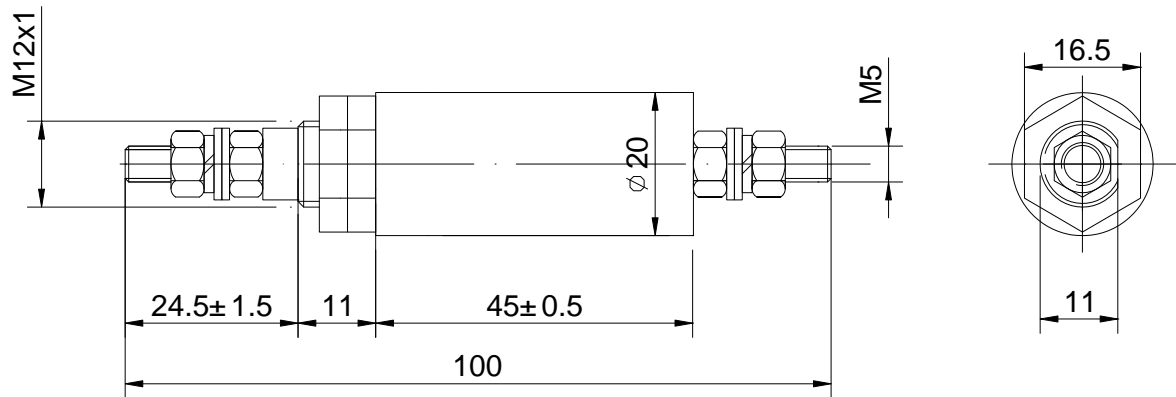

2. Specification:

Rated Voltage: 250VAC@50/60Hz, 600VDC

Rated Current: 10A

Test Voltage(2S): 2500VDC

Climatic Category: 25/085/56

3. Circuit Diagram:

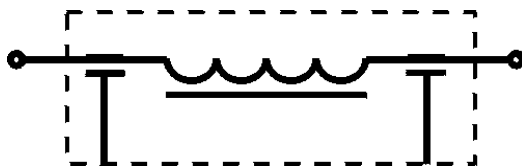

$$C=2 \times 18\text{nF} \pm 20\%$$

4. Insertion Loss in dB: (Measured in 50Ω system)

